



Scania R&S 2017-

Art. 864620

Laternakandur AERO TOP | Lamp holder AERO TOP | Носител фар AERO TOP | Scheinwerferbügel AERO TOP



- | | |
|---|----|
| 1. Look / arc / дуга / Bogen | 1 |
| 2. Look / arc / дуга / Bogen | 1 |
| 3. Klamber / clamp / зажим / Schelle | 8 |
| 4. Polt / bolt / болт / Bolzen M8x25 | 10 |
| 5. Mutter / nut / гайка / Mutter M8 | 8 |
| 6. Seib / flat washer / шайба / Scheibe 8,4x24x2 | 18 |
| 7. Vedruseib / spring washer / пружинная шайба / Federnscheibe A8 | 2 |
| 8. Tihend / gasket / прокладка / Dichtung | 1 |

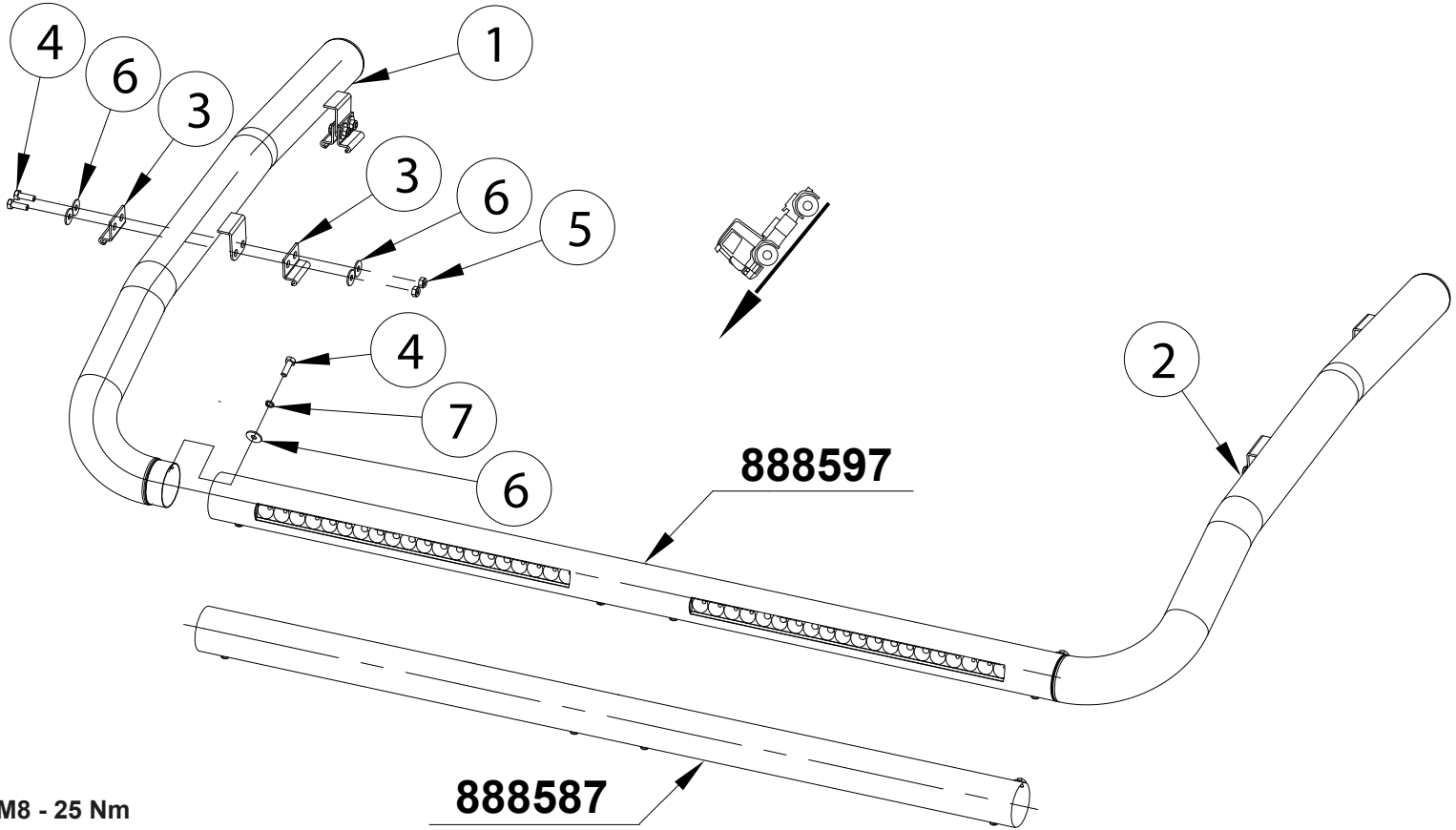

M8 - 25 Nm

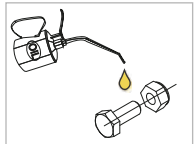

Kaal / Weight / Масса / Gewicht: 14,5 kg

Paigaldusaeg ilma elektritöödeta / Time of mounting w/o wiring works / Время установки без электромонт. работ / Einbauzeit ohne elektrische arbeit: 60 min

Vajalikud tööriistad / Required Tools / Необходимые инструменты / Benötigte Werkzeuge

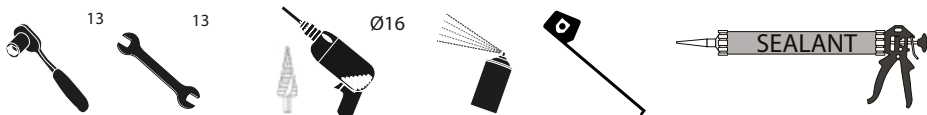

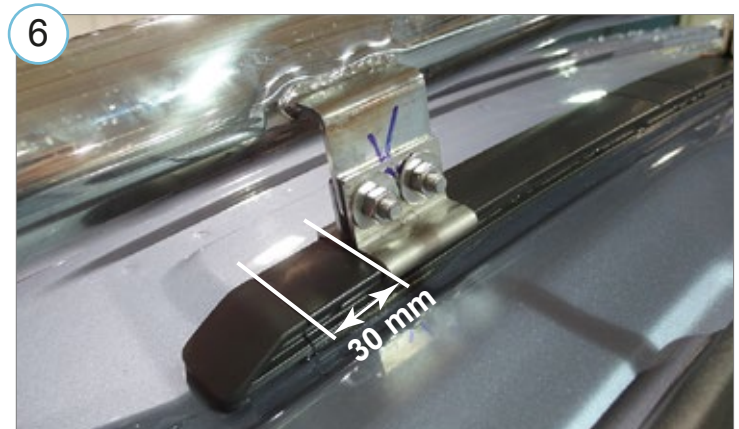
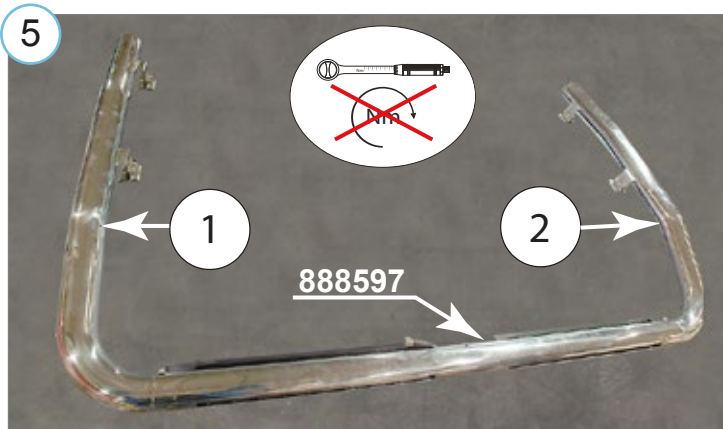
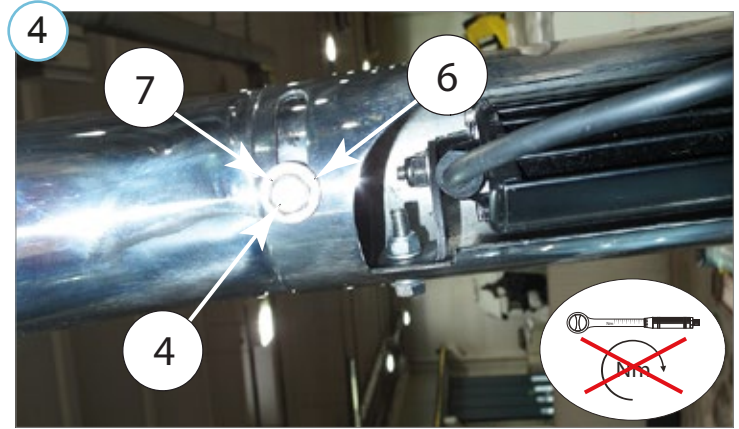
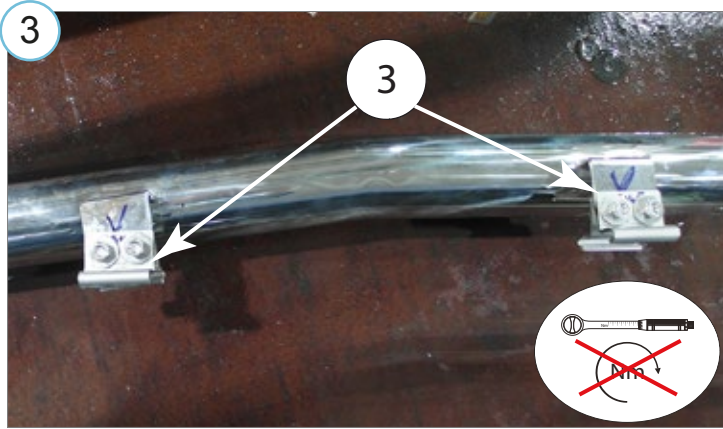
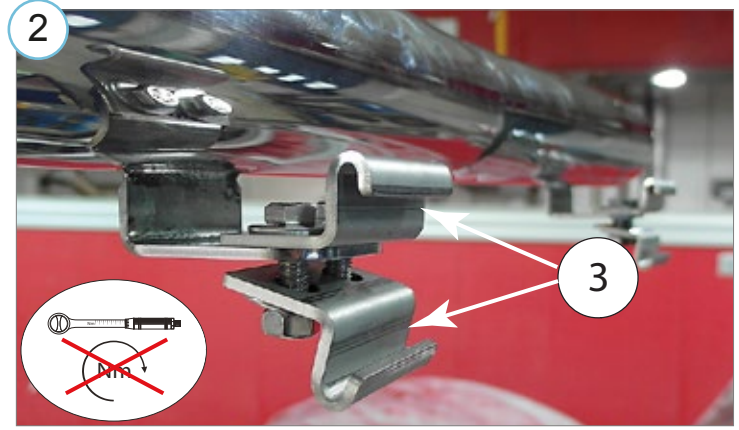
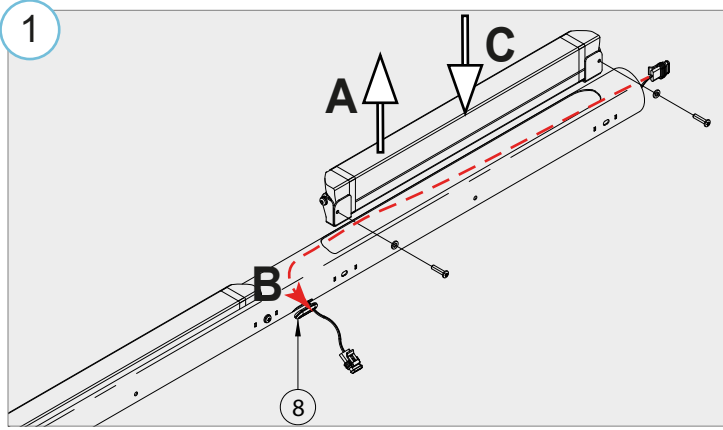

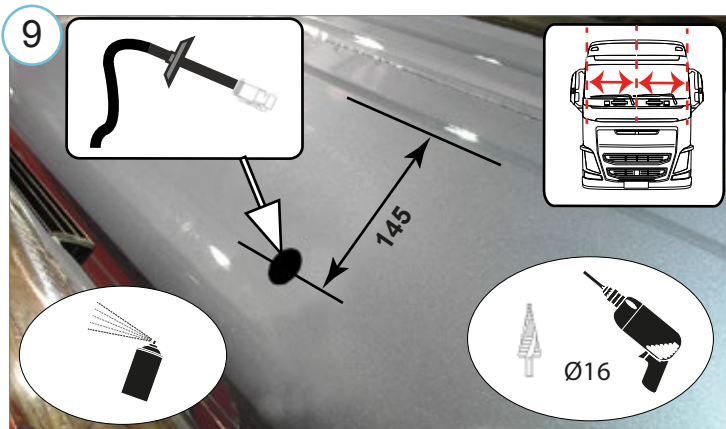

10 Elektriühendused teostada kvalifitseeritud autoelektriku poolt

Installation of the lights can be carried out by qualified electrician only

Монтаж огней может быть выполнено только квалифицированным электриком

Die Installation der Lichter können durchgeführt werden durch Elektrofachkraft

11 Lisalaternate paigaldise lubatud maksimaalne kogukaal (888587)

Allowed maximum weight of the installation of the extra lights in total is (888587)

Максимально допустимая общая масса установки дополнительных фар (888587)

Zulässiges Maximalgewicht der Installation der zusätzlichen Lichter insgesamt ist (888587)

6 kg

12

10 000 km

1	2	3	4	5	6	7
8	9	10	11	12	13	14
15	16	17	18	19	20	21
22	23	24	25	26	27	28
29	30	31				

1x

• Kui METEC toode ei vasta Teile ootustele või kui on tegemist toote ebapiisava kvaliteediga, siis pretensioonid esitada lehel www.metec.ee
• If the METEC product does not meet Your expectations or if it is a product of insufficient quality, then you can submit a claim at www.metec.ee
• Если METEC продукт не соответствует Вашим ожиданиям или это продукт недостаточного качества, то претензию предъявить можно на сайте www.metec.ee
• Wenn METEC Produkt nicht Ihren Erwartungen entspricht oder wenn es um Qualitätsmängel geht, dann bitte die Ansprüche auf Seite www.metec.ee einreichen

Lisa / extra / приложение / Extra

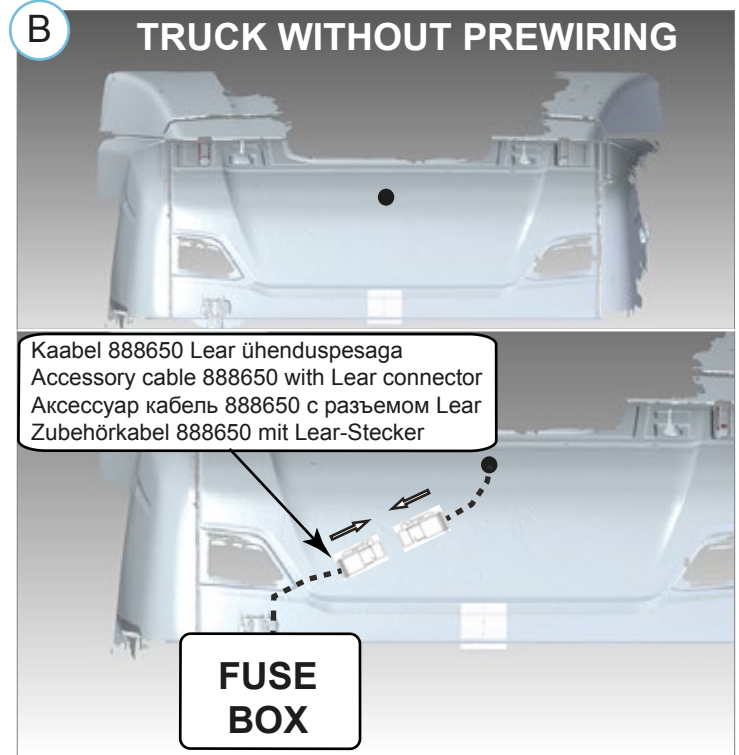
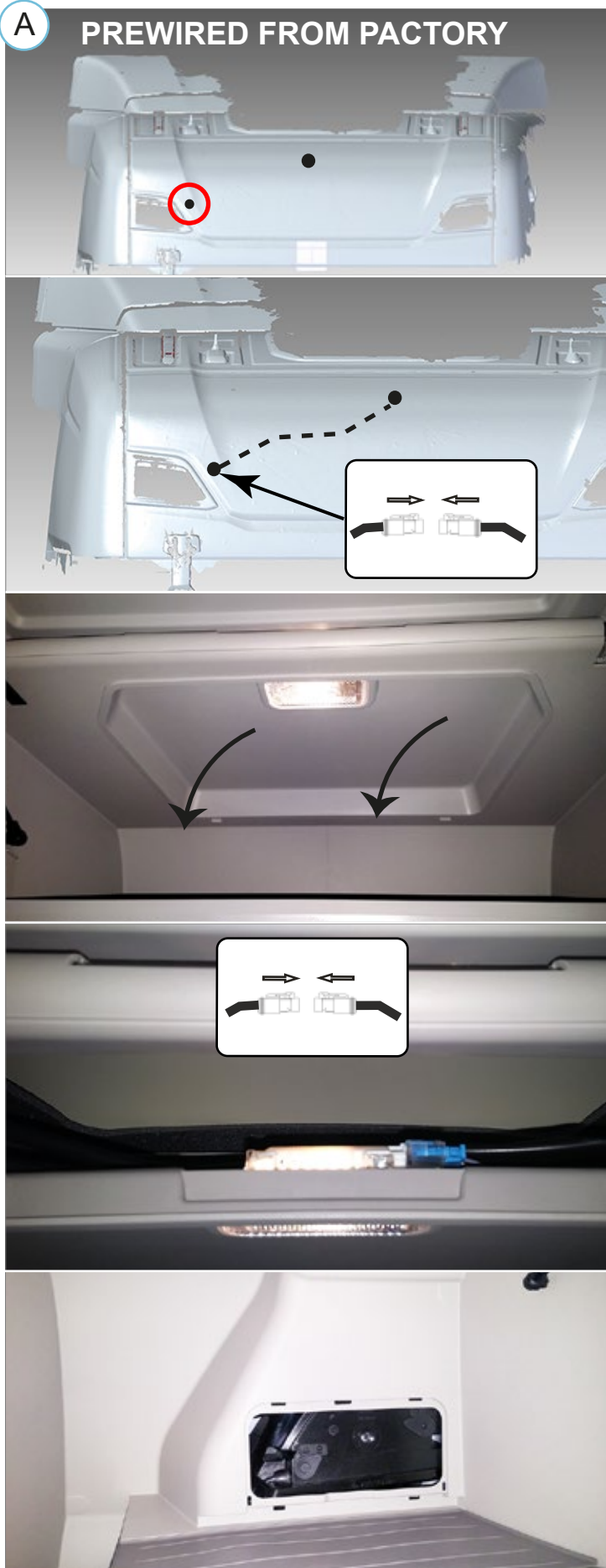

Switching pattern of the lights of the holder.

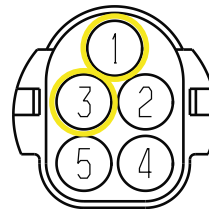

Position numbers seen from the side of holder /
ühenduspesade positsioonid kanduri poolt vaadates

A

A

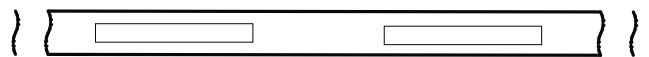

pin pattern / cross reference

Lear pin	crossing-light	ID 3G1,5
1	main beam (A)	b1
2		
3	earth/ground (A/B/C)	gy
4		
5		

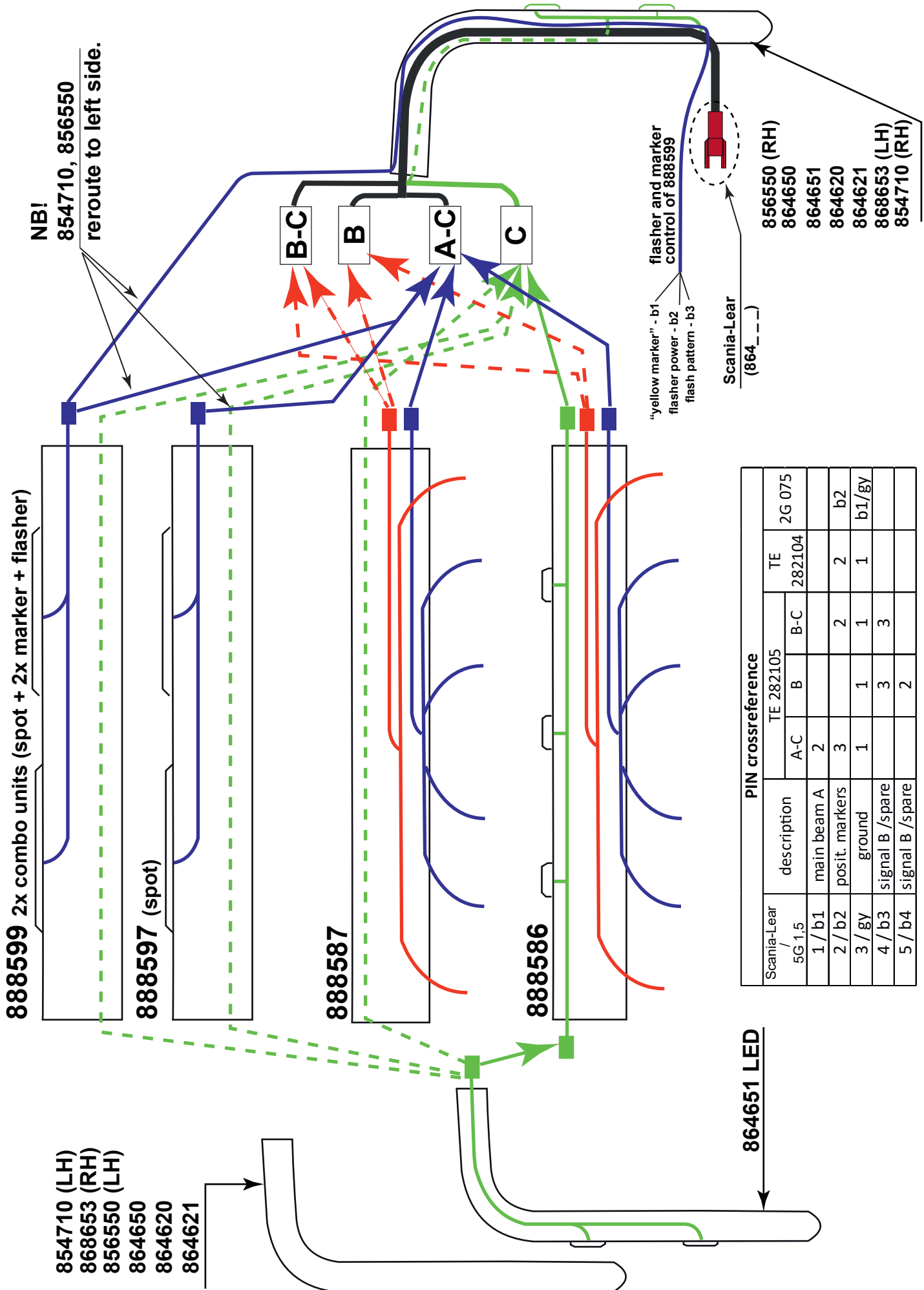

PIN crossreference

Scania-Lear 5G1.5	description	TE 282105			TE
		A-C	B	B-C	
1 / b1	main beam A	2			2G 075
2 / b2	posit. markers	3		2	b2
3 / gy	ground	1	1	1	b1/gy
4 / b3	signal B /spare		3	3	
5 / b4	signal B /spare		2		