



Volvo FH 13- Globetrotter/Globetrotter XL

Art. 868653, 888588

LED kanduri montaažikomplekt | Mounting kit for LED holder | Монтажный комплект для LED держателя |
Montagesatz für LED halter



- | | |
|--|----|
| 1. Look / arc / дуга / Bogen | 1 |
| 2. Look / arc / дуга / Bogen | 1 |
| 3. Vinkel / langed plate / угольник / Winkel | 2 |
| 4. Kronstein / bracket / кронштейн / Konsole | 1 |
| 5. Kronstein / bracket / кронштейн / Konsole | 1 |
| 6. T-polt / T-bolt / T-болт / T-bolzen | 2 |
| 7. U-polt / U-bolt / U-болт / U-bolzen | 2 |
| 8. Kompensaator / compensator / компенсатор / Kompensator | 2 |
| 9. Kompensaator / compensator / компенсатор / Kompensator | 4 |
| 10. Polt / bolt / болт / Bolzen M8x20 | 2 |
| 11. Polt / bolt / болт / Bolzen M8x25 | 6 |
| 12. Mutter / nut / гайка / Mutter M6 | 4 |
| 13. Mutter / nut / гайка / Mutter M8 DIN 934 | 2 |
| 14. Mutter / nut / гайка / Mutter M8 DIN 985 | 2 |
| 15. Seib / washer / шайба / Scheibe 6,4x18x1,6 | 12 |
| 16. Seib / washer / шайба / Scheibe 8,4x16x1,6 | 4 |
| 17. Seib / washer / шайба / Scheibe 8,4x24x2 | 8 |
| 18. Vedruseib / spring washer / пружинная шайба / Federnscheibe A8 | 8 |

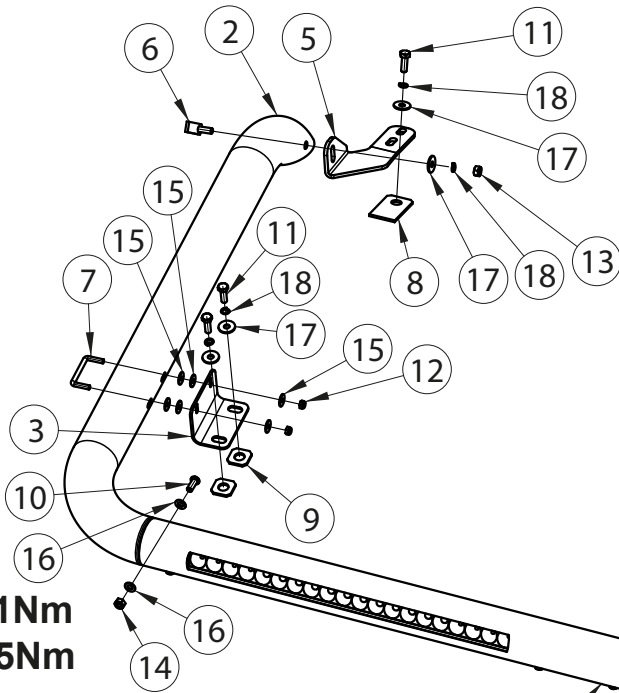

FWD

M6 - 11Nm
M8 - 25Nm

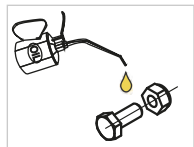

art. 888588

(müüakse eraldi/sold separately/
продается отдельно/ separat erhältlich)

Kaal / Weight / Масса / Gewicht: 868653 - 5kg; 888588 - 10kg

Paigaldusaeg / Time of mounting / Время установки / Einbauzeit: 60min

Vajalikud tööriistad / Required Tools / Необходимые инструменты / Benötigte Werkzeuge



Volvo FH 13- Globetrotter/Globetrotter XL

LED kanduri montaažikomplekt | Mounting kit for LED holder | Монтажный комплект для LED держателя | Montagesatz für LED halter

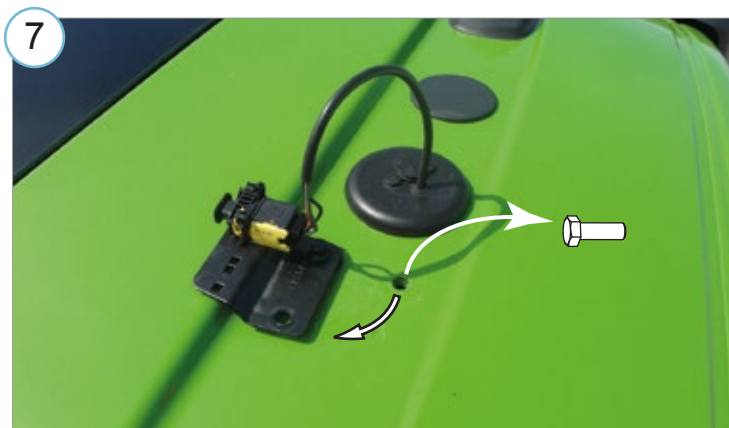
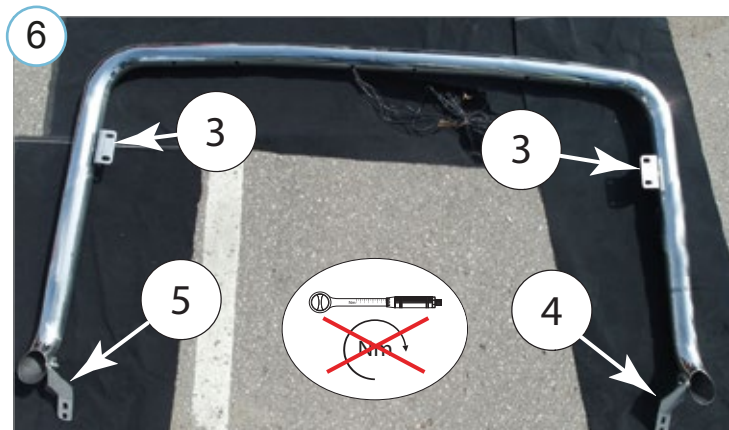
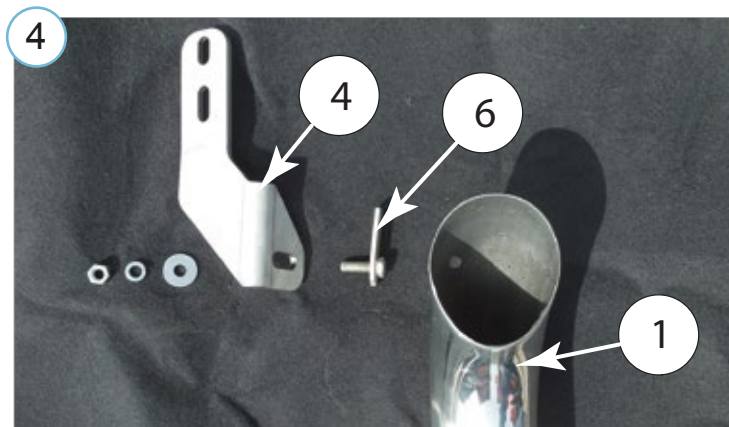
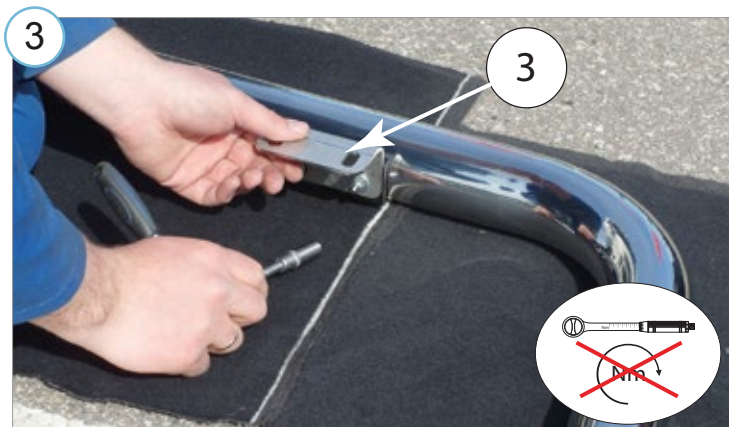
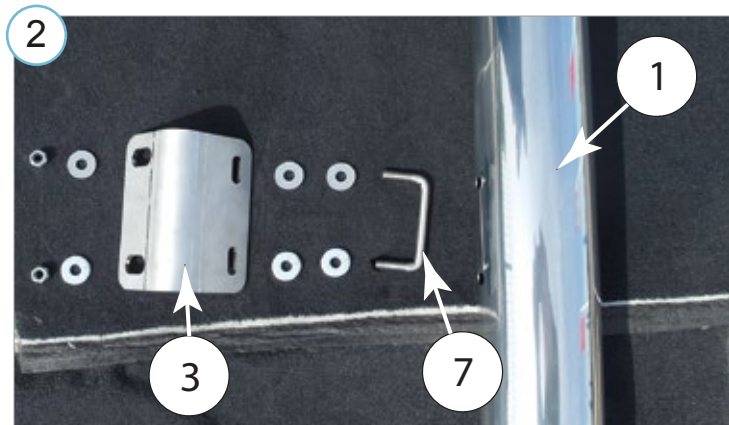
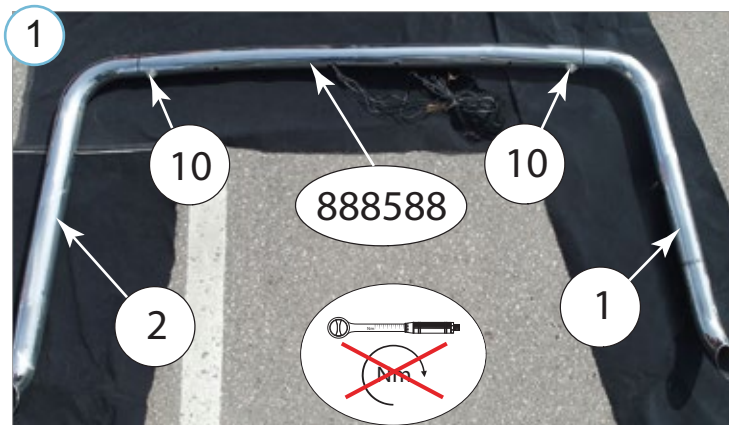

Volvo FH 13- Globetrotter/Globetrotter XL

LED kanduri montaažikomplekt | Mounting kit for LED holder | Монтажный комплект для LED держателя | Montagesatz für LED halter



10 Ettevaatust, oht kahjustada keeret!
Caution, risk of damage to thread!
Внимание! риск повреждения резьбы!
Vorsicht, Gefahr der Beschädigung fädeln!

9 mm
Auto kere / car body / кузов / Karosserie

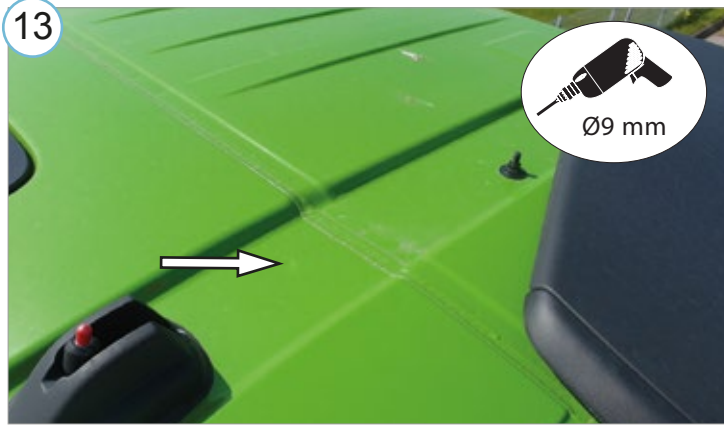
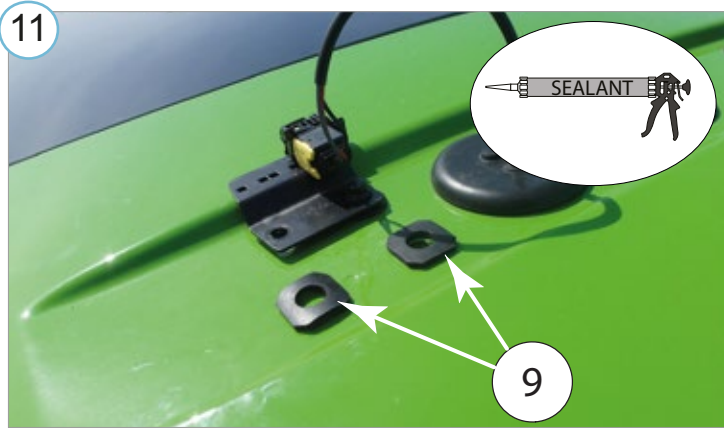

14 Ettevaatust, oht kahjustada keeret!
Caution, risk of damage to thread!
Внимание! риск повреждения резьбы!
Vorsicht, Gefahr der Beschädigung fädeln!

9 mm
Auto kere / car body / кузов / Karosserie

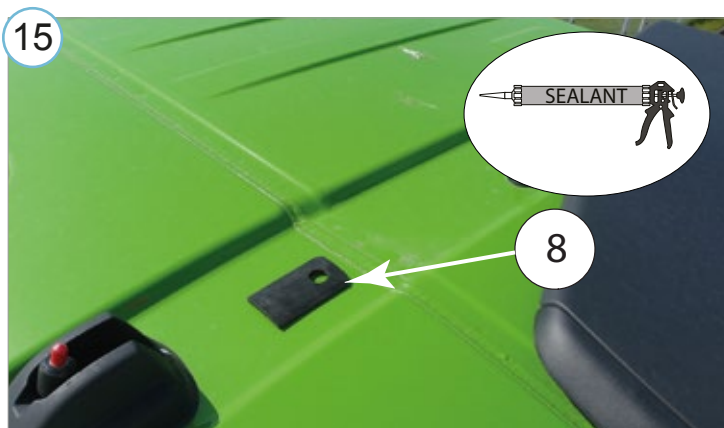

Volvo FH 13- Globetrotter/Globetrotter XL

LED kanduri montaažikomplekt | Mounting kit for LED holder | Монтажный комплект для LED держателя |
Montagesatz für LED halter

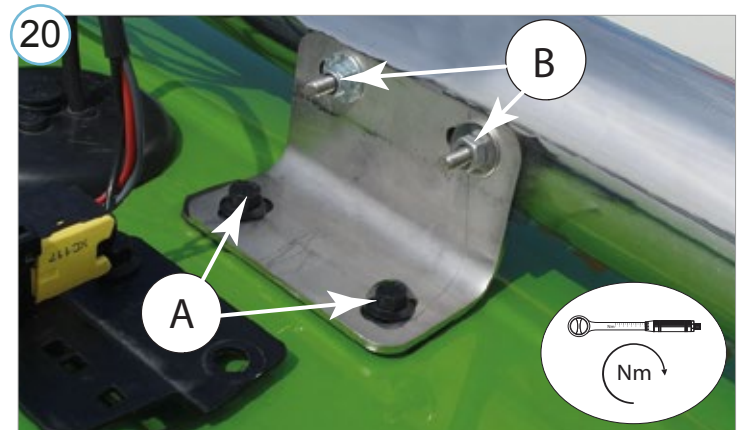
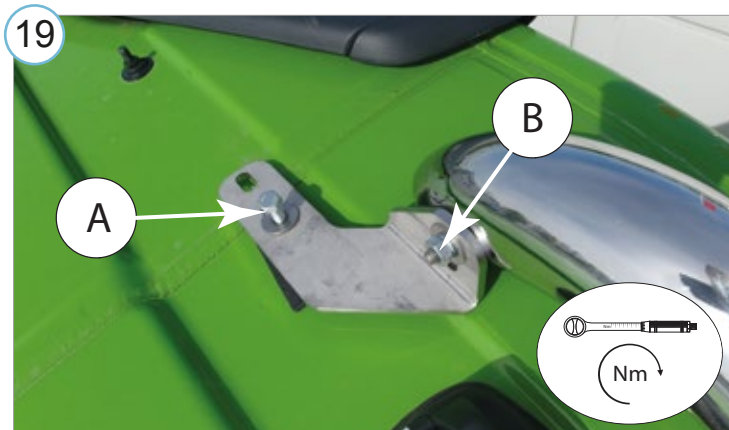
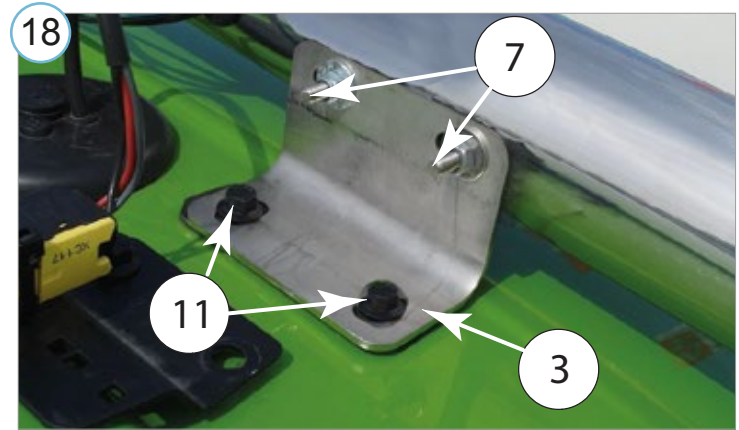
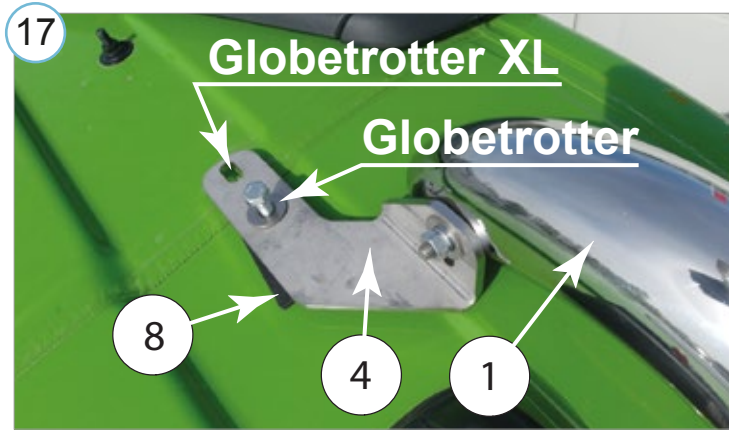

- Kui METEC toode ei vasta Teie ootustele või kui on tegemist toote ebapiisava kvaliteediga, siis pretensioonid esitada lehel www.metec.ee
- If the METEC product does not meet Your expectations or if it is a product of insufficient quality, then you can submit a claim at www.metec.ee
- Если METEC продукт не соответствует Вашим ожиданиям или это продукт недостаточного качества, то претензию предъявить можно на сайте www.metec.ee
- Wenn METEC Produkt nicht Ihren Erwartungen entspricht oder wenn es um Qualitätsmängel geht, dann bitte die Ansprüche auf Seite www.metec.ee einreichen

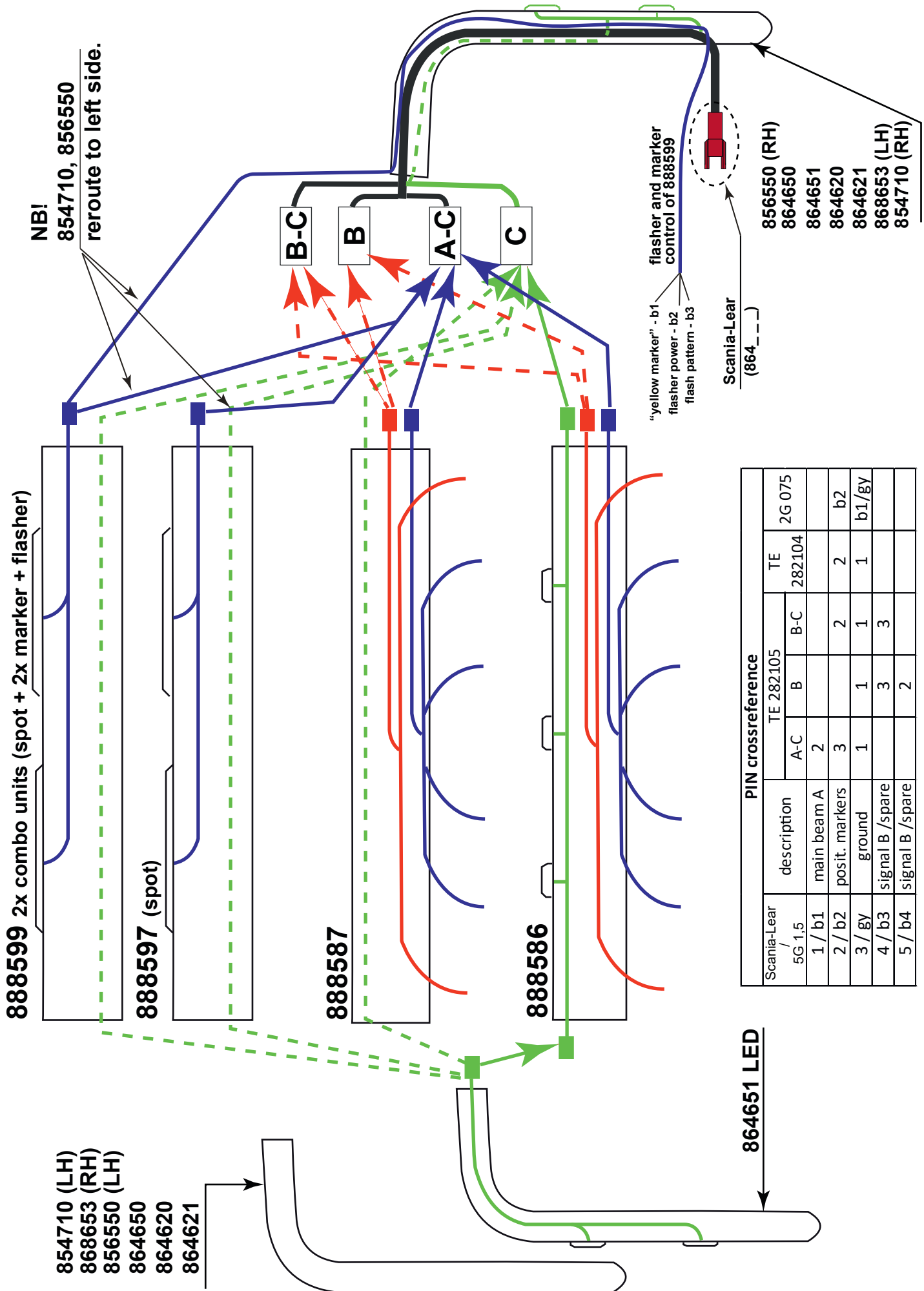

PIN crossreference

Scania-Lear 5G 1.5	description	TE 282105			TE 282104	2G 075
		A-C	B	B-C		
1 / b1	main beam A	2				
2 / b2	posit. markers	3		2	b2	
3 / gy	ground	1	1	1	b1/gy	
4 / b3	signal B /spare		3	3		
5 / b4	signal B /spare		2			

Switching pattern of the lights of the holder with OE connectors for XC117 and XC172 of factory prewiring "SPOT-R" / "SPOT-RF" and "BEACON-P"

Tube mounted Led marker lights "C" (if presented) are connected inside the tube and connected with potential position lights of the extra spot lights.

Juhtmesari võimaldab ühendada:

- B harudele kokku tarbimist kuni 15A
- A harudele kokku tarbimist kuni 15A

B haru võimaldab kas eraldi lülitust või kogu-koormuse jaotamist kaablisoonde vahel (vajalik juhtmete ümbertõstmise auto pistikus)

Wiring allows to connect:

- B looms with gross load of 15A
- A looms with gross load of 15A

B loom connected either as separate "switch-on" or used to distribute the load between the wires (repositioning wires in the truck can connector)

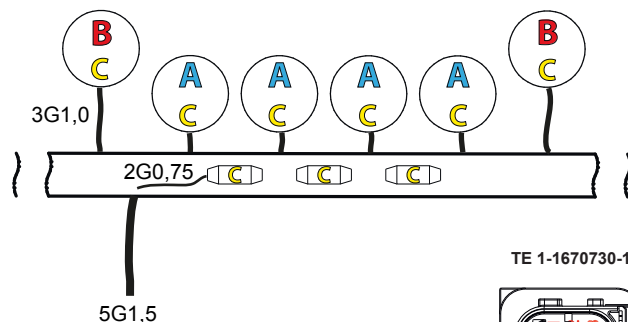

5G 1,5	description	TE 282105			TE282104	2G 075	TE 1-1670730-1	Volvo 60114164
		A-C	B	B-C	C			
b1	main beam A	2					1	
b2	posit. markers	3		2	2	b2	3	
g/y	ground	1	1	1	1	b1/gy	2	
b3	signal B /spare		3	3				1
b4	signal B /spare		2					2

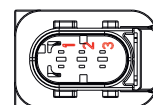

Volvo 60114164

