



MB Actros 25- GIGA

Mounting instructions
Art. 85667070, 85667071
Cabin side rails

Scan the QR code
for translated
instructions or visit
metec.ee/instructions



Weight: 12,8 kg
Time of mounting w/o wiring: 60 min

Required tools:



A2 / A4

M8 - 17 Nm

MB Actros 25- GIGA

Art. 85667070, 85667071

Cabin side rails

Pos	Description	QTY
1.	Tube	1
2.	Tube	1
3.	Bracket	1
4.	Washer	1
5.	Bracket	1
6.	Plate nut	1
7.	Bracket	1
8.	Bracket	1
9.	Bracket	1
10.	Bolt bracket	6
11.	Bolt M8x20 DIN7380-A2	26
12.	Nut M8 DIN985-A2	12
13.	Flat Washer 6,4x18x1,6	38
14.	Spring washer A8	14

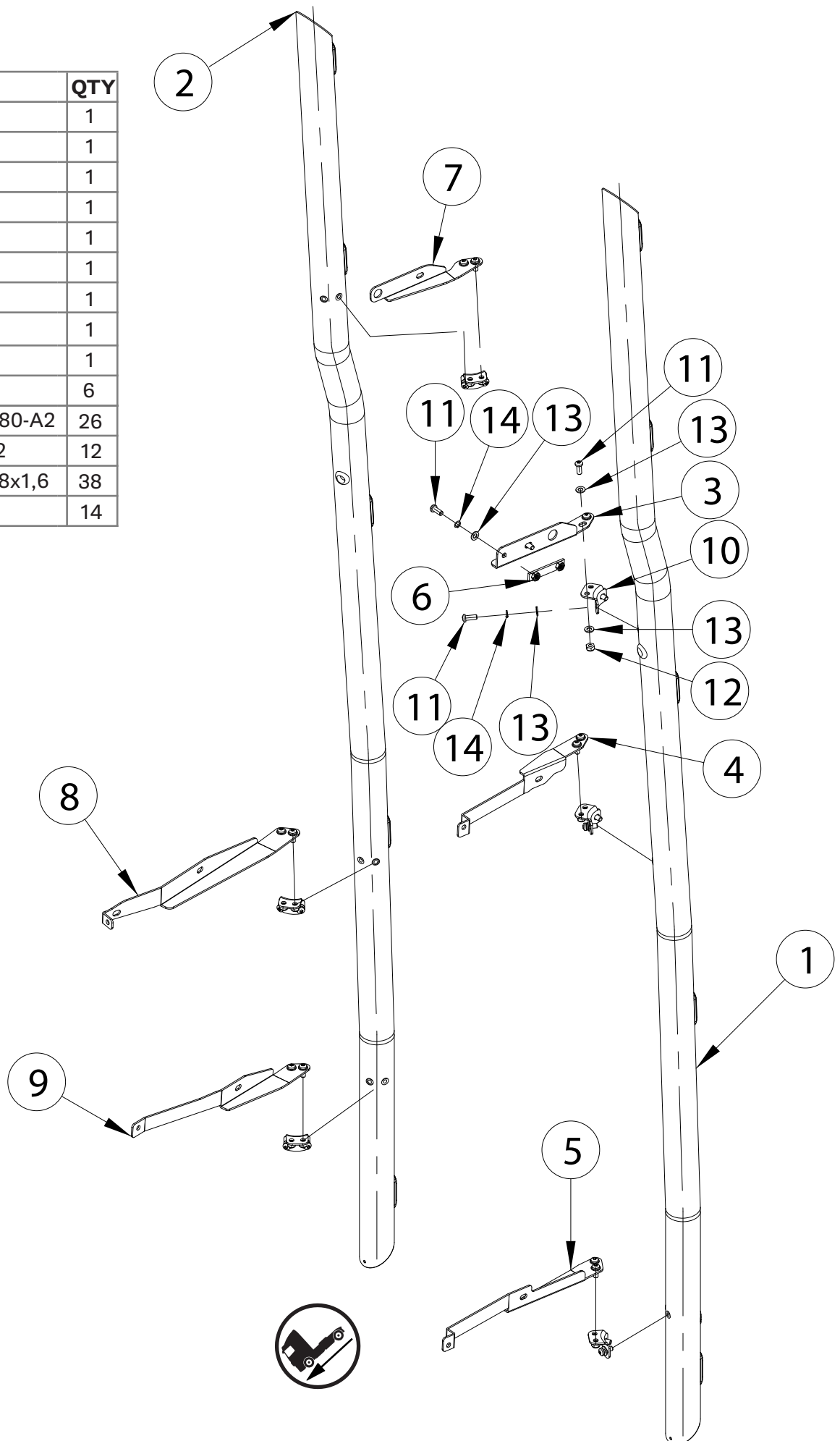

MB Actros 25- GIGA

Art. 85667070, 85667071

Cabin side rails

NB!



To prevent cold welding, use cold weld grease or engine oil



Installation of the lights must be carried out by a qualified electrician only

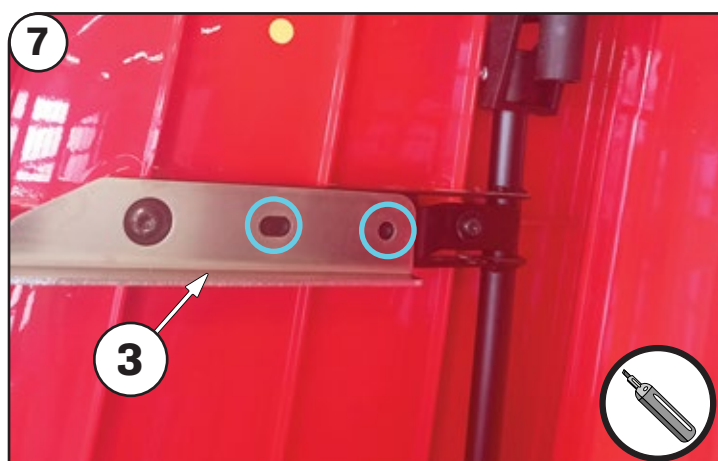
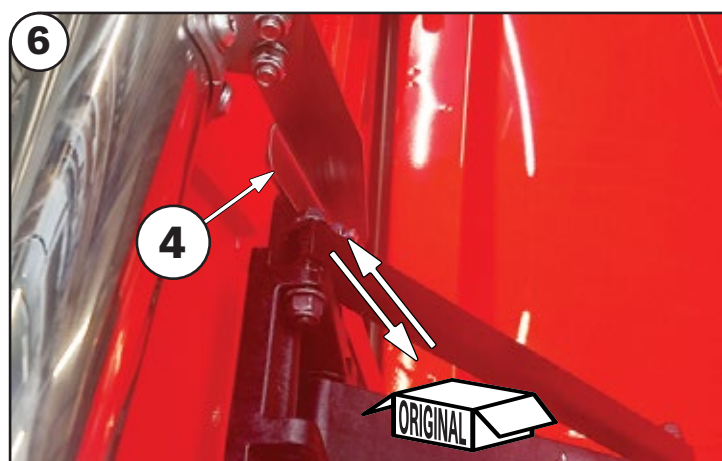
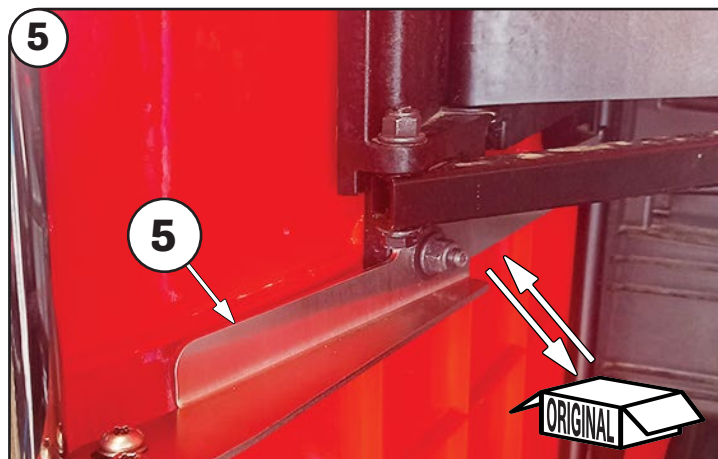
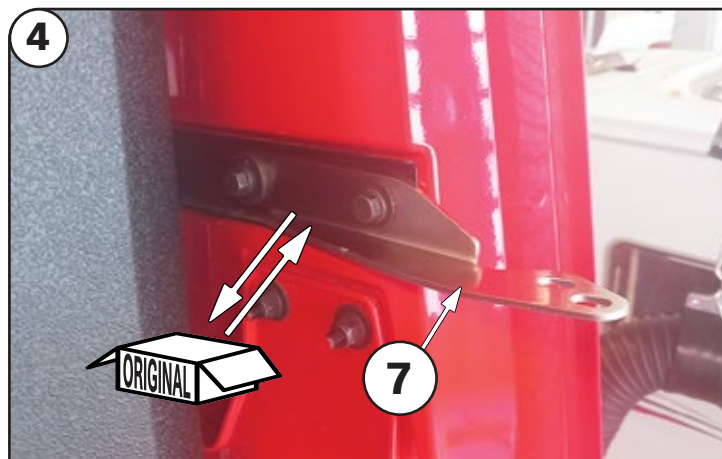
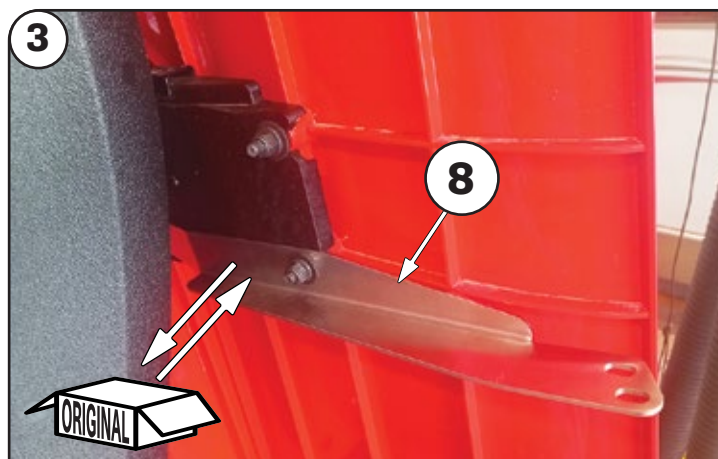
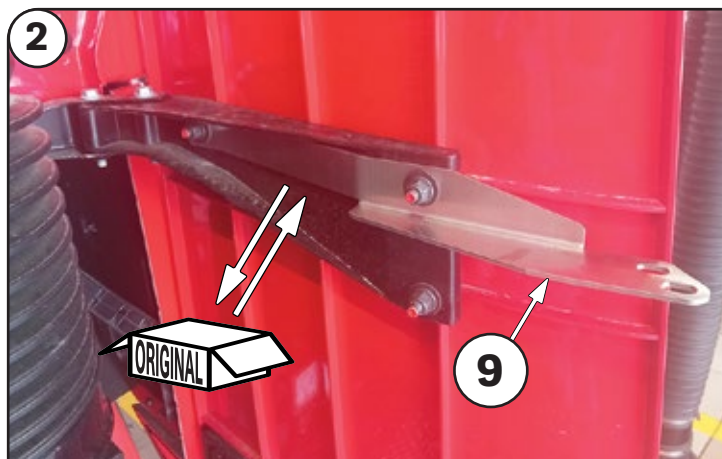
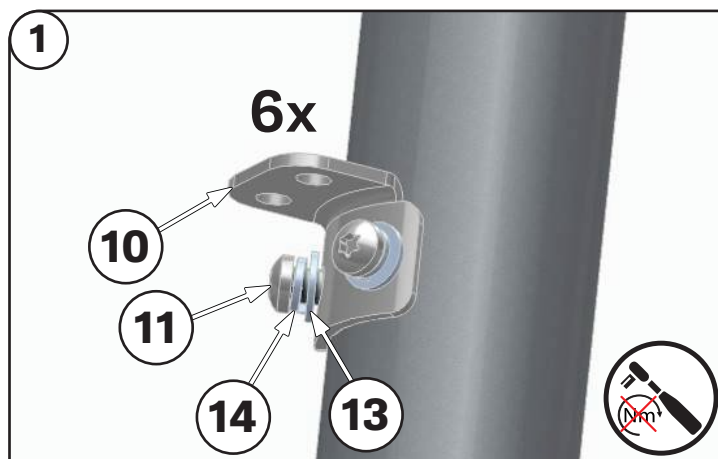

MB Actros 25- GIGA

Art. 85667070, 85667071

Cabin side rails

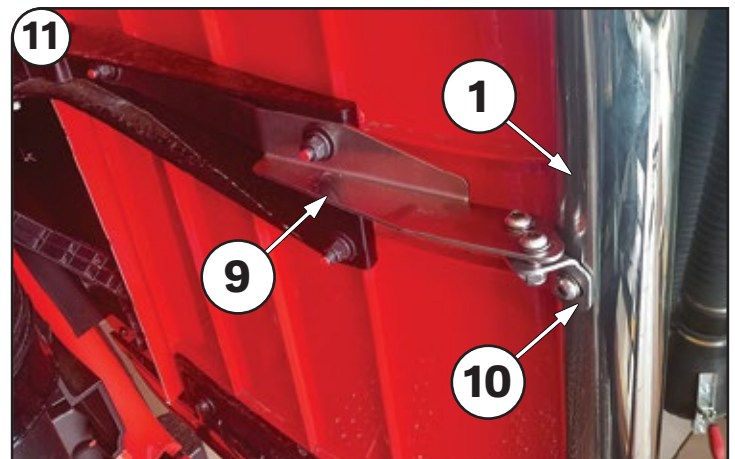
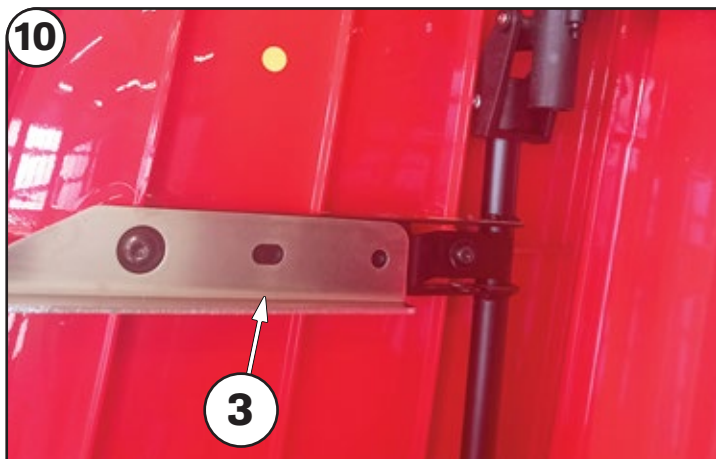
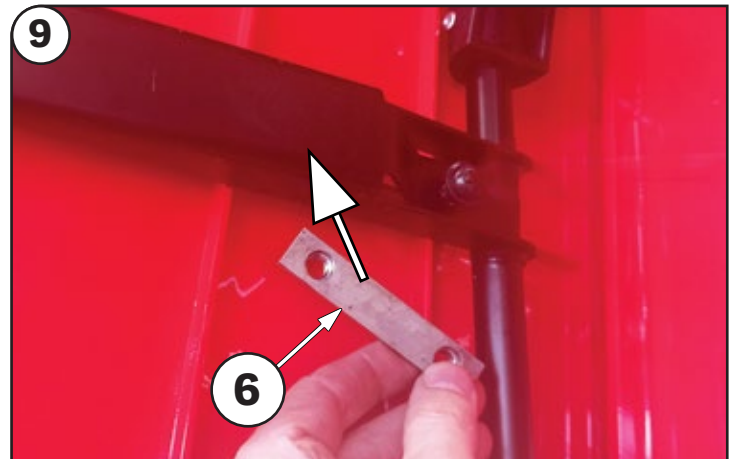
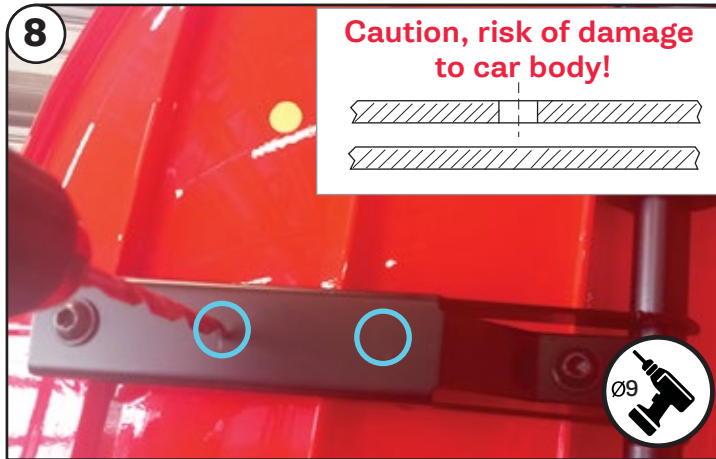

Check and retighten the fasteners:
Road vehicles: every 10 000km
Heavy machinery: every 500 work hours



Clean the product twice a month to remove dirt, salt, and debris that may cause surface discoloration or rust spots

In case of any defects or damage to the METEC product upon delivery, contact the reseller or point of sale where you made your purchase for resolution