



# MAN TG-S 2007- M&L cab, MAN TG-X 2007- XL cab

Art. 854144, 854145, 854144701, 85414572

Laternakandur Ø70mm | Lamp holder Ø70mm | Носител фар Ø70mm | Scheinwerferbügel Ø70mm



- |   |   |
|---|---|
| 1. Laternakandur / lamp holder / носител фар /<br>scheinwerferbügel   | 1 |
| 2. Kronstein / bracket / кронштейн / Konsole                          | 1 |
| 3. Kronstein / bracket / кронштейн / Konsole                          | 1 |
| 4. Klamber / clamp / зажим / Schelle                                  | 6 |
| 5. Klamber / clamp / зажим / Schelle                                  | 6 |
| 6. Kronstein / bracket / кронштейн / Konsole                          | 2 |
| 7. Puks / bushing / букса / Buchse                                    | 2 |
| 8. Kompensator / compensator / компенсатор /<br>Kompensator M8        | 2 |
| 9. Polt / bolt / болт / Bolzen M6x20                                  | 2 |
| 10. Polt / bolt / болт / Bolzen M8x20                                 | 4 |
| 11. Polt / bolt / болт / Bolzen M8x40                                 | 2 |
| 12. Polt / bolt / болт / Bolzen M8x75                                 | 2 |
| 13. Mutter / nut / гайка / Mutter M6                                  | 2 |
| 14. Mutter / nut / гайка / Mutter M8                                  | 2 |
| 15. Seib / washer / шайба / Scheibe 6,4x12x1,6                        | 4 |
| 16. Seib / washer / шайба / Scheibe 8,4x24x2                          | 4 |
| 17. Vedruseib / spring washer / пружинная шайба /<br>Federnscheibe A8 | 8 |

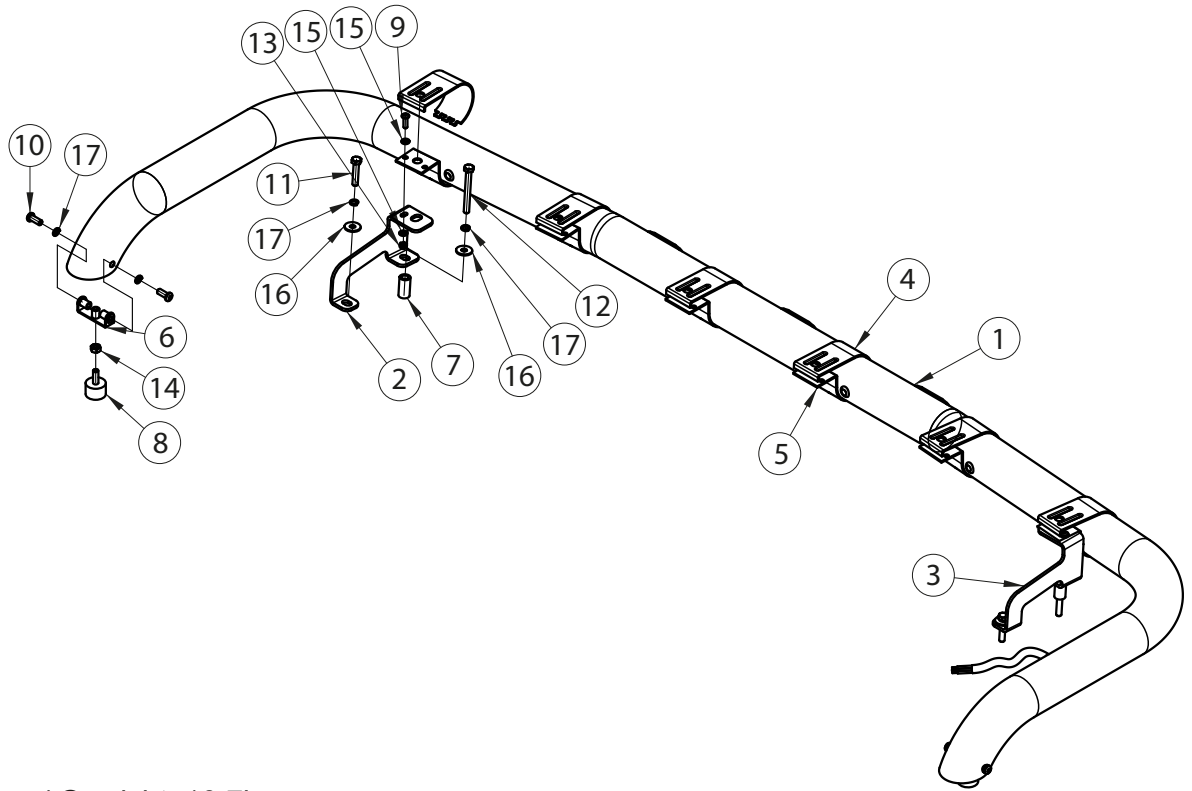

**M6 - 11Nm**

**M8 - 25Nm**

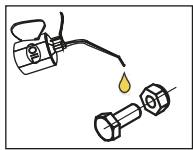

Kaal / Weight / Масса / Gewicht: 10,7kg

Paigaldusaeg / Time of mounting / Время установки / Einbauzeit: 45min

Vajalikud tööriistad / Required Tools / Необходимые инструменты / Benötigte Werkzeuge



MAN TG-S 2007- M&L cab, MAN TG-X 2007- XL cab

Laternakandur Ø70mm | Lamp holder Ø70mm | Носител фар Ø70mm | Scheinwerferbügel Ø70mm

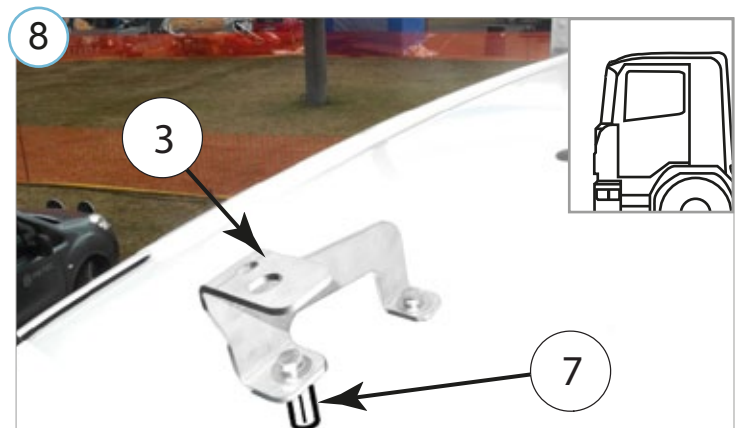
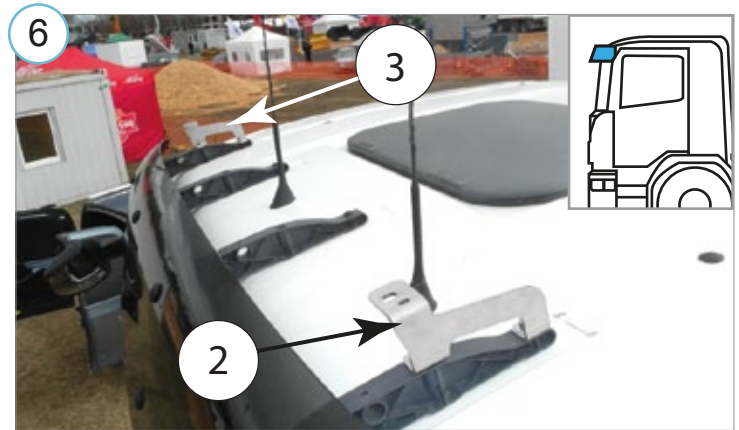
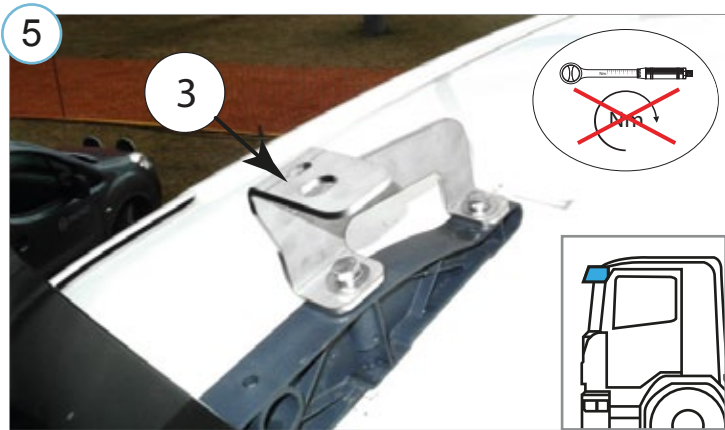
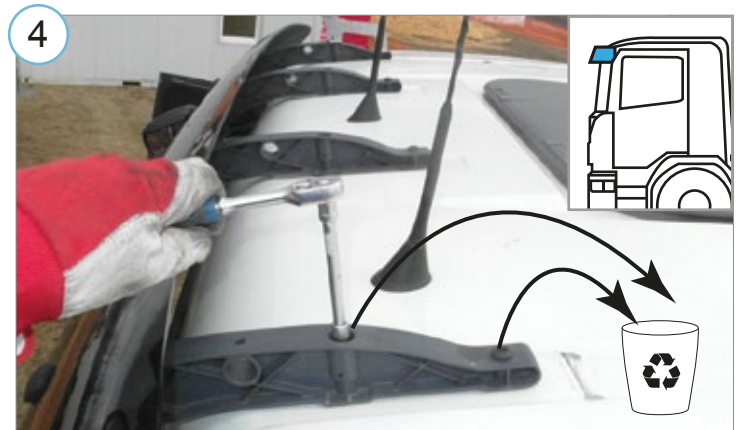
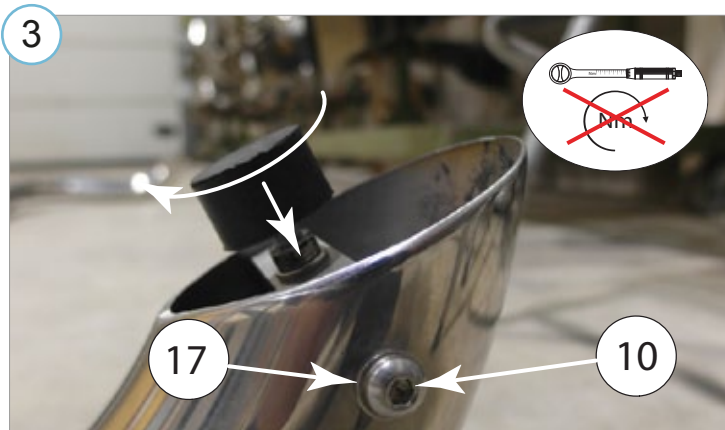
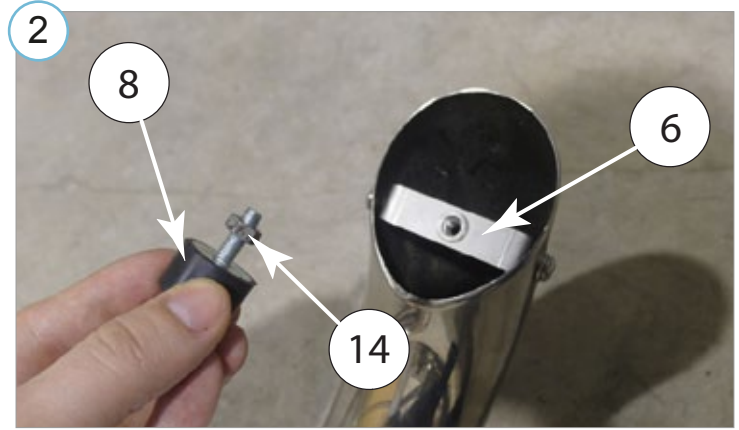
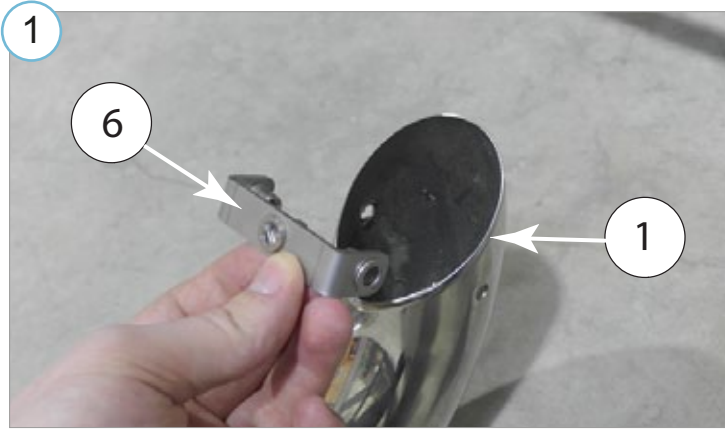

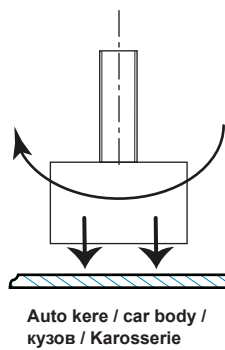
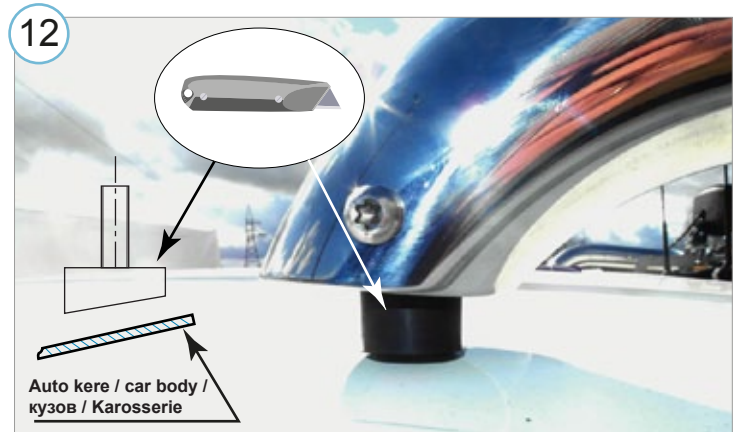
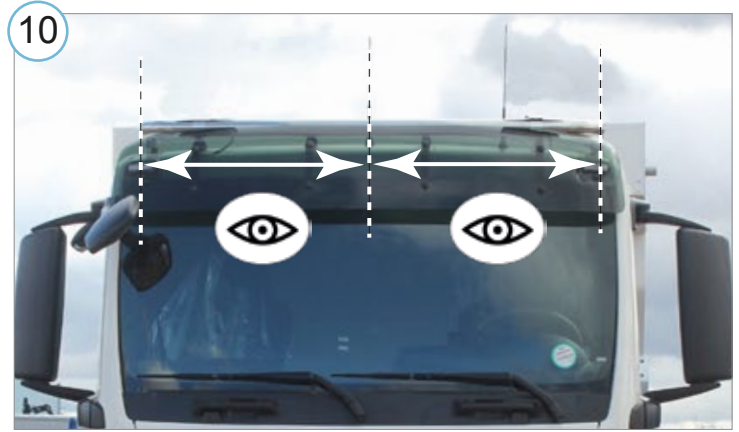
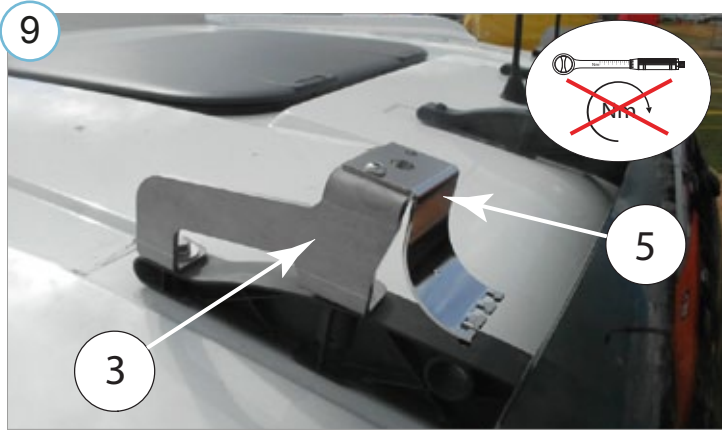

Keera kompensator tugevalt vastu kere

Screw compensator firmly against the car body

Компенсатор плотно прилегать к кузову

Schraube Kompensators fest gegen die Karosserie

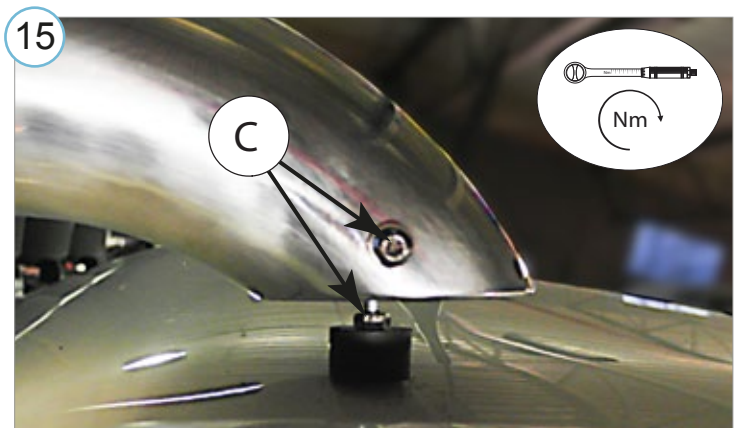
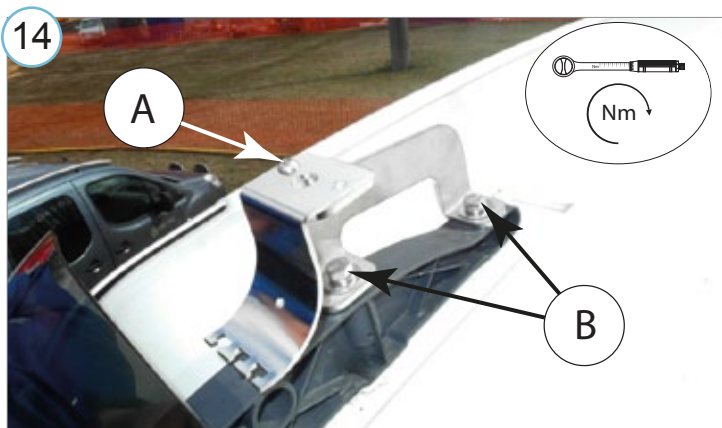

**MAN TG-S 2007- M&L cab, MAN TG-X 2007- XL cab**

Laternakandur Ø70mm | Lamp holder Ø70mm | Носител фар Ø70mm | Scheinwerferbügel Ø70mm

16

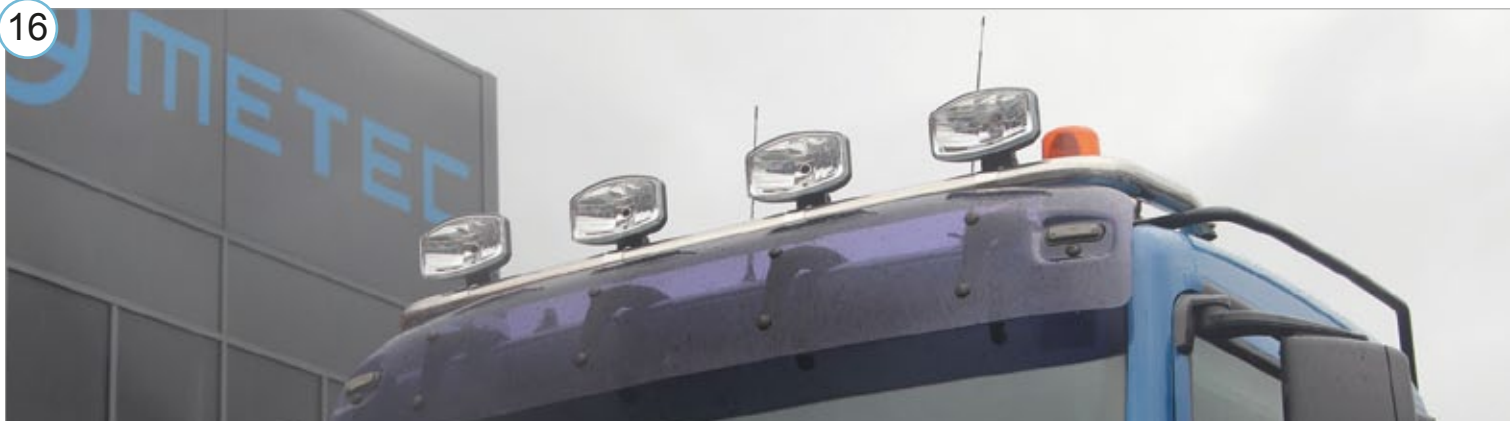

- Kui METEC toode ei vasta Teile ootustele või kui on tegemist toote ebapiisava kvaliteediga, siis pretensioonid esitada lehel [www.metec.ee](http://www.metec.ee)
- If the METEC product does not meet Your expectations or if it is a product of insufficient quality, then you can submit a claim at [www.metec.ee](http://www.metec.ee)
- Если METEC продукт не соответствует Вашим ожиданиям или это продукт недостаточного качества, то претензию предъявить можно на сайте [www.metec.ee](http://www.metec.ee)
- Wenn METEC Produkt nicht Ihren Erwartungen entspricht oder wenn es um Qualitätsmängel geht, dann bitte die Ansprüche auf Seite [www.metec.ee](http://www.metec.ee) einreichen